



## Selwyn Close, Mildenhall, Suffolk, IP28 7QA

Rent - £1,100 PCM      Deposit - £1,269

A modern 3 bedroom house located on the outskirts of Mildenhall and accessible to Mildenhall and Lakenheath Air Bases, the property has recently had a new kitchen and has had new flooring and been decorated throughout.

The property is also accessible to A11 via Fiveways roundabout which gives access to Newmarket, Norwich, Bury St Edmunds etc.

- MID TERRACED HOUSE
- 3 BEDROOMS
- MODERN KITCHEN
- FAMILY BATHROOM
- ENCLOSED REAR GARDEN
- CLOSE TO RAF BASES
- GAS HEATING & ENERGY RATING - C
- APPROXIMATE SIZE - 861 SQFT
- COUNCIL TAX BAND - A
- AVAILABLE NOW



Council Tax Band: A - EPC Rating: D 62

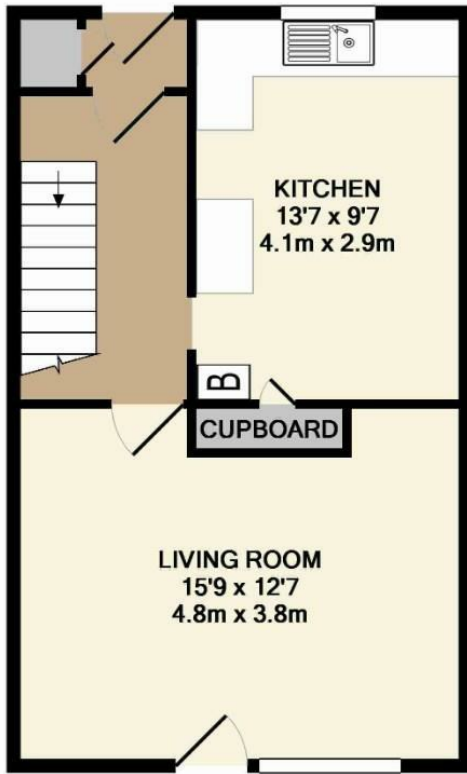

GROUND FLOOR  
APPROX. FLOOR  
AREA 413 SQ.FT.  
(38.4 SQ.M.)

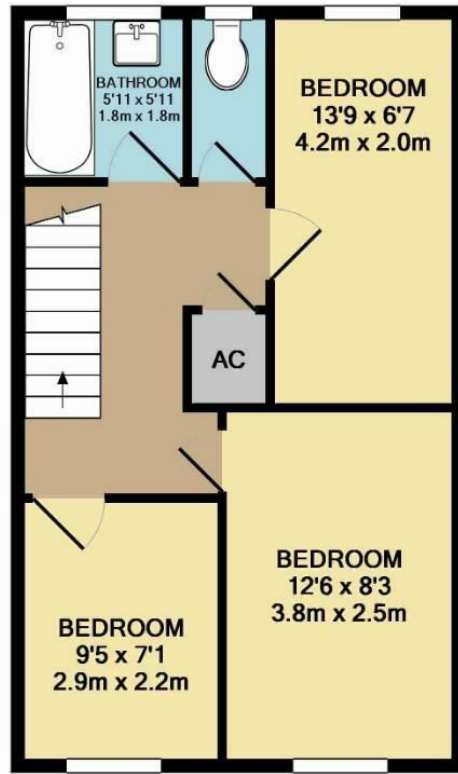

1ST FLOOR  
APPROX. FLOOR  
AREA 403 SQ.FT.  
(37.4 SQ.M.)

TOTAL APPROX. FLOOR AREA 816 SQ.FT. (75.8 SQ.M.)

Whilst every attempt has been made to ensure the accuracy of the floor plan contained here, measurements of doors, windows, rooms and any other items are approximate and no responsibility is taken for any error, omission, or mis-statement. This plan is for illustrative purposes only and should be used as such by any prospective purchaser. The services, systems and appliances shown have not been tested and no guarantee as to their operability or efficiency can be given  
Made with Metropix ©2012

